

DULCOFLEX - DFXa

Intelligent peristaltic metering pump!



ProMinent®

Capacity range 0.038 GPD (6 ml/h) to 17.7 gph (65 l/h)

The ProMinent® DULCOFLEX - DFXa is an intelligent peristaltic metering pump that is valve-free and has the accuracy of a diaphragm pump. Applications include gaseous, highly viscous, abrasive, shear-sensitive and chemically aggressive fluids.

The liquid end of the pump is designed for a quick and simple replacement of the tubing, utilizing a unique exchange process. The pump display provides precise instructions on the steps required for the tube replacement. High-performance tubing consists of a TPV (Santoprene), PUR (Polyurethane), or SEBS (Styrene ethylene butylene styrene) material that provides excellent chemical resistance and a long service life.

The DULCOFLEX - DFXa is powered by a DC motor and will provide continuous metering from 0.038 GPD (6 ml/h) to 17.7 gph (65 l/h). Additional features such as communication protocol includes PROFIBUS, CANbus, Modbus and PROFINET.

Features & Benefits

- NSF61 Approved
- Volume adjustment in GPH or LPH
- Manual, Analog, Contact and Batch modes optional
- High visibility of LED-indicator lights
- Large, illuminated display
- New configurable input/output port
- Pump is available as an FDA design
- CIP (cleaning in place) enabled system
- Turn down ratio up to 3,000:1
- Reverse flow is possible
- Dosing head can be aligned in four directions: Left, Right, Up and Down
- Integrated 7-day timer
- Viscosities to 10,000 cPs

Field of application

- Drinking water and wastewater treatment
- Food and beverage industry
- Paper industry
- Chemical industry
- All industrial applications, either as a stand-alone unit or integrated in a complete system

DULCOFLEX - DFXa

Technical Data

Capacity Data										
Pump Version	Capacity at Maximum Backpressure				Max. Speed	Connector Size	Suction Lift		Shipping Weight	
	psig	(bar)	gph	(l/h)			ft	(m)	lbs	(kg)
DULCOFLEX - DFXa										
0530	73	(5)	8.00	(30)	100	1/2" x 3/8"	29.5	(9)	12.8	(5.8)
0730	102	(7)	8.00	(30)	100	1/2" x 3/8"	29.5	(9)	12.8	(5.8)
0365	44	(3)	17.17	(65)	100	1/2" x 3/8"	29.5	(9)	12.8	(5.8)
0565	73	(5)	17.17	(65)	100	1/2" x 3/8"	29.5	(9)	12.8	(5.8)

Tube material:..... TPV (Santoprene): **available with pump versions 0730 and 0530**
 PUR (Polyurethane): **available with pump version 0530 and 0565 only**
 SEBS (Styrene ethylene butylene styrene) **available with pump version 0365 only**
 Tube connectors:..... PVDF/PTFE
 Metering reproducibility: $\pm 2\%$ with retracted tube (after approx. 200 revolutions)
 Turndown:..... 3,000:1
 Electrical connection:..... 100 - 230 V $\pm 10\%$, 50/60 Hz
 Nominal power:..... approx. 45 W
 Degree of protection:..... IP 66, NEMA 4X Indoor
 Permissible ambient temperature:..... 32 - 113 °F (0 - 45 °C)
 Optional relay modules:..... 1 x switch over contact, 230 V – 8 A or 2 x On, 24 V – 100 mA
 Capacity data represents minimum values, tested using water at 68 °F (room temperature)

Dimensions

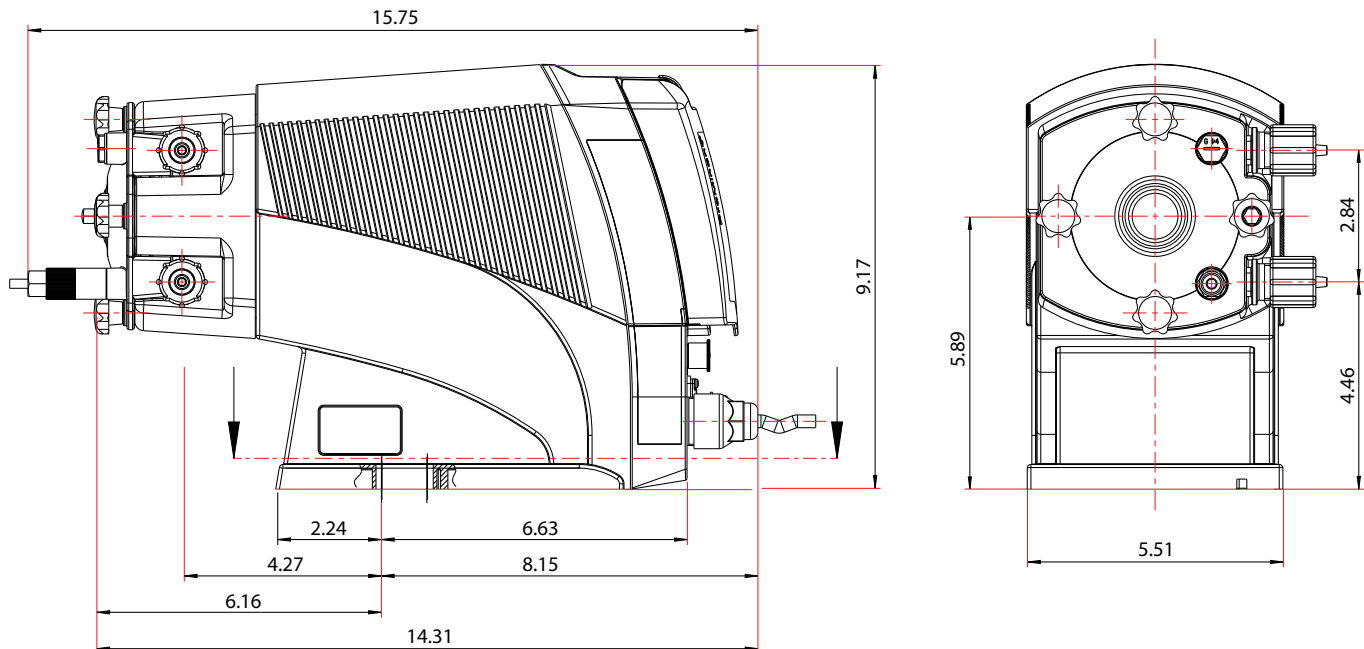

Note: All above measurements are in inches

ProMinent Fluid Controls, Inc. (USA)
 136 Industry Drive • Pittsburgh, PA 15275
 Ph: (412) 787-2484 • email: prominentcsd-us@prominent.com
www.prominent.us

ProMinent Fluid Controls, Ltd. (Canada)
 490 Southgate Drive • Guelph, N1G 4P5
 Ph: (519) 836-5226 • Toll Free: 1-888-709-9933
 email: sales-can@prominent.com
www.prominent.ca