

ProMinent® Sigma/3 Motor-Driven Metering Pumps

ProMinent®

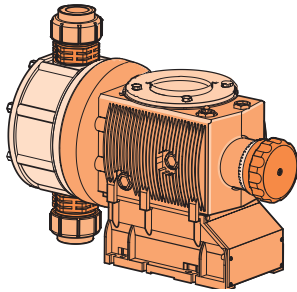

Basic Version (S3Ba HM)
(without motor)

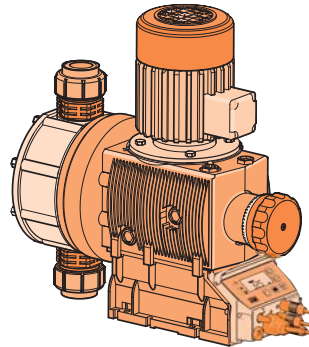

Control Version (S3Ca HM)
(with motor)

Sigma/3 Metering Pumps

The ProMinent Sigma/3 series is a motor driven, mechanically actuated diaphragm type (HM) metering pump available in a basic version or with microprocessor control. It is constructed of a rugged metal inner casing for components subjected to mechanical stress, and a corrosion resistant plastic outer housing.

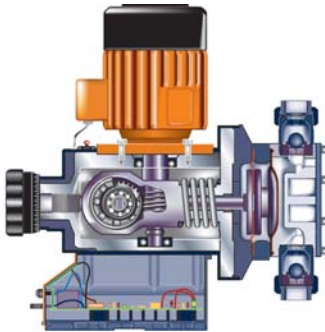

S3Ca HM cutaway

Sigma/3 diaphragm pumps are designed with a convex DEVELOPAN diaphragm which seals to a concave curve in the liquid end. This allows for precise metering of media with various viscosities and reduces stress for long diaphragm life. Liquid ends are available in PVDF or SS.

Three gear ratios and two liquid end sizes provide maximum capacities ranging from 46 to 264 gph (174 to 1000 L/h) with maximum backpressures of 174 to 58 psi (12 to 4 bar). The capacity can be varied in steps of 0.5% by adjustment of the self-locking stroke length adjusting knob or via an optional stroke positioning motor. Maximum stroke length is 0.24" (6 mm).

Under defined conditions and with correct installation, the repeatability is better than +/-2% in a stroke length range of between 30 and 100%.

Control versions

Basic type The Sigma/3 basic version (S3Ba) does not include internal electronics or a motor. Any NEMA 56 C 1750 RPM motor can be supplied including explosion-proof or inverter duty AC motors. The Sigma/3 uses a 3/4 HP single or 3-phase motor.

The pump may be operated manually by adjusting the stroke length knob (displacement per stroke). Automatic control of displacement per stroke via a 4-20 mA analog or 3P signal is possible with optional servomotor. Control of stroke frequency via analog signal is possible with variable speed drives (DC/SCR or AC inverter).

Control type The Sigma/3 microprocessor controlled metering pump (S3Ca) is supplied with an integral TEFC motor. Pump settings are programmable and viewed on an illuminated LCD. Functions include stroke frequency, batch delivery and external control by pulse or analog signal.

The Sigma/3 control version features information displays for flow rate (in gph or l/h) and totalized flow (gallons or litres); accumulative stroke count with clear/reset capabilities; and stroke length adjustment displayed in increments of 1%. Three LED lights indicate operating status. Options include a programmable access code, flow monitoring, fault and pacing relays, calibration, timer and 4-20 mA output.

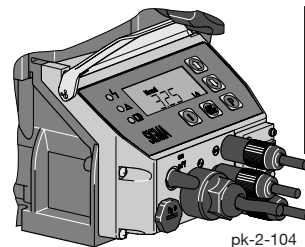

pk-2-104



Technical Data: Sigma/3 HM Diaphragm Pumps

Capacity at Maximum Backpressure					Max. Stroke Rate	Output per Stroke	Recomm. Motor HP	Max Suction Lift (water)	Max. Suction Pressure	Suction/Discharge Connector	Approximate Shipping Weight w/ Motor
Pump type	psig (bar)	U.S. GPH	Stroke/min. (S3B/S3C)	Stroke/min. (S3B/S3C)		mL/stroke	HP	ft. (m)	psig (bar)	in. DN MNPT	lbs. (kg)
S3Ba/S3Ca											
120145 PVT	145 (10)	46	(174)	86/90		31.5	3/4	16 (5)	29 (2)	1 25	49 (22)
120145 SST	174 (12)	46	(174)	86/90		31.5	3/4	16 (5)	29 (2)	1 25	57 (26)
120190 PVT	145 (10)	60.2	(228)	124/120		31.5	3/4	16 (5)	29 (2)	1 25	49 (22)
120190 SST	174 (12)	60.2	(228)	124/120		31.5	3/4	16 (5)	29 (2)	1 25	57 (26)
120270 PVT	145 (10)	85.6	(324)	173/180		31.5	3/4	16 (5)	29 (2)	1 25	49 (22)
120270 SST	174 (12)	85.6	(324)	173/180		31.5	3/4	16 (5)	29 (2)	1 25	57 (26)
070410 PVT	100 (7)	130	(492)	86/90		95.1	3/4	13 (4)	14.5 (1)	1 1/2 32	53 (24)
070410 SST	100 (7)	130	(492)	86/90		95.1	3/4	13 (4)	14.5 (1)	1 1/2 32	64 (29)
070580 PVT	100 (7)	184	(696)	124/120		95.1	3/4	13 (4)	14.5 (1)	1 1/2 32	53 (24)
070580 SST	100 (7)	184	(696)	124/120		95.1	3/4	13 (4)	14.5 (1)	1 1/2 32	64 (29)
040830 PVT	58 (4)	264	(1000)	173/180		95.1	3/4	10 (3)	14.5 (1)	1 1/2 32	53 (24)
040830 SST	58 (4)	264	(1000)	173/180		95.1	3/4	10 (3)	14.5 (1)	1 1/2 32	64 (29)

Wetted Materials of Construction

Material Code	Liquid end	Suction/Discharge Connectors	Seals*	Valve (ball) DN 25	Valve DN 32 (plate)
PVT	PVDF (Polyvinylidene fluoride)	PVDF (Polyvinylidene fluoride)	PTFE/ Viton®	Glass	Ceramic
SST	316 Stainless steel	316 Stainless steel	PTFE/ Viton®	SS	Hastelloy C

* EPDM/Viton® also available.

Viton® is a registered trademark of DuPont Dow Elastomers.

Diaphragm Failure Indicators

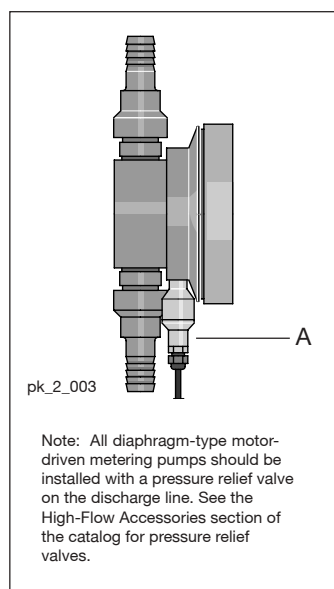

Diaphragm Failure Monitor (A)

As an option, the liquid end can be equipped with diaphragm failure monitor. This consists of a PVDF spacer with leak detector positioned between the primary (fluid side) diaphragm and a hermetically sealed backer diaphragm. A normally closed diaphragm-isolated pressure switch (A) opens upon the increase of pressure resulting from main diaphragm failure, based on minimum backpressure of 21 psig (1.5 bar). This offers the distinct advantage that the metered fluid cannot flow uncontrolled out of the pump. The diaphragm failure is signalled on an LCD display and the pump is stopped on SICa models, and triggers the optional fault indicating relay. A contact is opened on SIBa HM models to allow fault annunciation or to stop the pump.

Diaphragm Failure Kits

For conversion of a standard Sigma pump to one with diaphragm failure indication. Includes safety diaphragm, backplate, secondary containment diaphragm and hub, leak detection spacer, leak detection pressure switch assembly, diaphragm, pump head bolts.

330 S3BA (version 120145 - 120270)	1004596
330 S3CA (version 120145 - 120270)	1004597
1000 S3BA (version 070410 - 040830)	1004594
1000 S3CA (version 070410 - 040830)	1004595

Specifications: Sigma/3

General:

<i>Maximum stroke length:</i>	0.236" (6.0 mm)		
<i>Power cord:</i>	6 foot (2 m) 2 wire + ground (supplied on control version)		
<i>Stroke frequency control:</i>	S3Ba: Constant speed or optional DC/SCR drive or AC inverter S3Ca: Microprocessor control version with innovative start/stop and variable speed control proportional to set frequency or external control signal.		
<i>Stroke counting:</i>	Standard on S3Ca		
<i>Materials of construction</i>			
<i>Inner casing:</i>	Cast aluminum		
<i>Housing:</i>	Glass-filled Luranyl™ (PPE)		
<i>Wetted materials of construction:</i>	Liquid End:	PVDF	316 SS
<i>Suct./Dis. Connectors:</i>	PVDF	316 SS	
	Seals:	PTFE/Viton®	PTFE/Viton®
	Check Balls: DN 25	Glass	SS
	Check Plates: DN 32	Hastelloy C	Hastelloy C
	Pressure Relief Valves:	PVDF/Viton® O-rings	SS/Viton® O-rings
<i>Drive:</i>	Cam and spring-follower (lost motion)		
<i>Lubrication:</i>	Oil lubricated		
<i>Recommended oil:</i>	ISO VG 460, such as Mobil Gear Oil 634; ProMinent Part no. 555325		
<i>Oil quantity:</i>	Approximately 0.95 quart (900 mL)		
<i>Recommended oil change interval:</i>	5,000 hours		
<i>Warranty:</i>	Two years on drive, one year on liquid end.		
<i>Factory testing:</i>	Each pump is tested for rated flow at maximum pressure.		
<i>Industry Standard:</i>	CE approved, CSA available (standard in Canada)		
<i>Diaphragm materials:</i>	PTFE faced EPDM with Nylon reinforcement and steel core		
<i>Liquid end options:</i>	Polyvinylidene Fluoride (PVDF) or 316 SS, with PTFE faced Viton® seals		
<i>Check valves:</i>	DN 25 valves - Single ball check, PVDF and SS versions. Optional springs available (Hastelloy C4) DN 32 valves - Plate valves, with Hastelloy C4 plates and springs in both PVDF and SS valves.		
<i>Repeatability:</i>	When used according to the operating instructions, better than ±2%		
<i>Max. fluid operating temperatures:</i>	<u>Material</u>	<u>Constant</u> (Max. Backpressure)	<u>Short Term</u> (15 min. @ max.30 psi)
	PVDF	149½°F(65½°C)	212½°F(100½°C)
	316 SS	194½°F(90½°C)	248½°F(120½°C)
<i>Diaphragm failure indication:</i>	Optional, see accessories. Switch is N.C., opens to indicate failure. Switch rated 250 VAC, 0.3 A inductive or 0.5 A resistive; 30 VDC, 1.0 A resistive. Requires minimum 21 psig (1.5 bar) backpressure on pump. N.O. switch available upon request. Includes double diaphragm leak prevention.		
<i>Separation of drive from liquid end:</i>	An air gap with secondary safety diaphragm separates the drive from the liquid end to prevent cross contamination of oil and process fluid (with or without optional diaphragm failure indication).		
<i>Max. solids size in fluid:</i>	0.3 mm		
<i>Stroke length adjustment:</i>	Manual, in increments of 0.5%. Motorized stroke length adjustment available.		

Specifications cont.

Basic Version

<i>Motor mounting flange:</i>	Fits all NEMA 56C frame motors (motor not included with pump)
<i>Gear ratios and stroke frequencies (with 1725 RPM motor):</i>	20:1 = 86 SPM, 14:1 = 124 SPM, 10:1 = 173 SPM
<i>Motor coupling:</i>	Flexible coupling included with pump.
<i>Required Motor HP:</i>	3/4 HP (.55 kW)
<i>Full load RPM:</i>	1750 RPM (60 Hz)
<i>Stroke sensor (optional):</i>	Hall effect - requires 5 VDC

Control Version

<i>Control Function:</i>	At stroke frequencies equal to or greater than 33%, the integral AC variable frequency drive continuously varies the motor speed in a linear response to the incoming signal. At stroke frequencies less than 33%, the motor starts and stops according to a control algorithm to provide the desired stroke frequency. In the start-stop mode the motor speed is constant at approximately 580 RPM.
<i>Enclosure rating:</i>	NEMA 3 (IP 55)
<i>Motor data:</i>	Totally enclosed, fan cooled (IP55); class F insulation; Manufacturer ATB; 0.37 kW (0.5 HP) 230 3 phase (1.9 A)
<i>Thermal overload protection:</i>	Thermal cutout switches off at 284½°F (140½°C).
<i>Relay cable (optional):</i>	6 foot (2 m) 3 wire (SPDT) 250 VAC, 2 A
<i>Relay load</i>	
<i>Fault relay only (options 1 & 3):</i>	Contact load: 250 VAC, 2 A, 50/60 Hz Operating life: > 200,000 switch functions
<i>Fault and pacing relay (options 4 & 5):</i>	Contact load: 24 V, 2 A, 50/60 Hz Operating life: > 200,000 switch functions Residual impedance in ON-position (R_{DSOn}): < 8 Ω Residual current in OFF-position: < 1 μ A Maximum voltage: 24 VDC Maximum current: < 100 mA (for pacing relay) Switch functions: 750x10 ⁶ Contact closure: 100 ms (for pacing relay)
<i>Analog output signal:</i>	max. impedance 300 Ω Isolated 4-20 mA output signal
<i>Profibus - DP fieldbus options:</i>	Transfer: RS - 485 Wiring: 2-wired, twisted, shielded Length: 3637 ft. (1200 m)/328 ft. (100 m) Baudrate: 9600 bits/s; 12 Mbits/s No. of participants: 32 with 127 repeaters Topology: Line Access procedure: Master/master with token ring
<i>Pulse contact/ Remote pause contact:</i>	With voltage-free contact, or semiconductor sink logic control (not source logic) with a residual voltage of <700 mV. The contact load is approximately 0.5 mA at + 5 VDC. (Note: Semiconductor contacts that require >700 mV across a closed contact should not be used).
<i>Max. pulse frequency:</i>	25 pulses/sec
<i>Contact impedance:</i>	10 kOhm
<i>Max. pulse memory:</i>	65,535 pulses
<i>Necessary contact duration:</i>	20ms
<i>Analog - current input burden:</i>	Approximately 120 Ohm
<i>Max. allowable input current:</i>	50 mA
<i>Power requirements:</i>	115 VAC or 230 VAC single phase

Data required to size metering pumps and accessories

Complete this data sheet and fax it to ProMinent Pittsburgh at (412) 787-0704 or ProMinent Canada at (519) 836-5226 for a review of the system hydraulics and recommendations on pump and accessory selection.

Desired capacity min./max.	GPH (l/h) _____
Available power supply	_____ V, _____ Hz, _____ phase
Working temperature min./max.	°F (°C) _____
Description of process fluid	_____
Concentration %	_____
Solids content %	_____
Absolute viscosity, cP	_____
Vapor pressure at working temperature	psig (bar) _____
Remarks (e.g. abrasive, developing gases and fumes, flammable, corrosive)	_____ _____
Suction conditions:	
Suction lift min./max., or	ft. (m) _____
Positive suction head min./max., or	ft. (m) _____
Pressure in chemical tank	psig (bar) _____
Length of suction line	ft. (m) _____
Size (I.D.) of suction line	in. (mm) _____
Number of valves and fittings in suction line	_____
Discharge conditions:	
Back-pressure min./max.	psig (bar) _____
Discharge head min./max.	ft. (m) _____
Negative discharge head min./max.	ft. (m) _____
Length of discharge line	ft. (m) _____
Size (I.D.) of discharge line	in. (mm) _____
Number of valves and fittings in discharge line	_____

System sketch

Identity code: Basic Version Sigma/3 HM (S3Ba)

Series:
Sigma/3 Basic
Version a

H	Main Drive, Diaphragm											
	120145 120190 120270 070410 070580 040830	Pump version:										
	PV SS	Liquid end material: PVDF 316 Stainless steel										
	T	Seal material: PTFE/Viton® seal Viton® is a registered trademark of DuPont Dow Elastomers										
	0 1	Diaphragm type: Standard diaphragm With double diaphragm and failure monitor (NC contact opens on fault)										
	0 1	Liquid end version: Without valve springs With 2 valve springs (Hastelloy C4, 1 psig) (standard for 070410, 070580, 040830)										
	7 8	Connectors: PVDF clamping nut & insert SS clamping nut & insert										
	0	Labeling: Standard with logo										
	2	Motor mount: Without motor, with NEMA 56C flange										
	0	Enclosure rating: Standard										
	0 2	Stroke sensor: Without stroke sensor (Standard) With Pacing relay (Consult Factory)										
	0 1 2 4 6	Stroke length adjustment: Manual (Standard) With 3P stroke positioning motor, 230 V 50/60 Hz With 3P stroke positioning motor, 115 V 50/60 Hz W/ stroke positioning motor 4 - 20 mA, 230 V 50/60 Hz W/ stroke positioning motor 4 - 20 mA, 115 V 50/60 Hz										
S3Ba	H	120145	PV	T	0	0	7	0	2	0	0	0

Dimensions: Sigma/3 HM Basic (S3Ba)

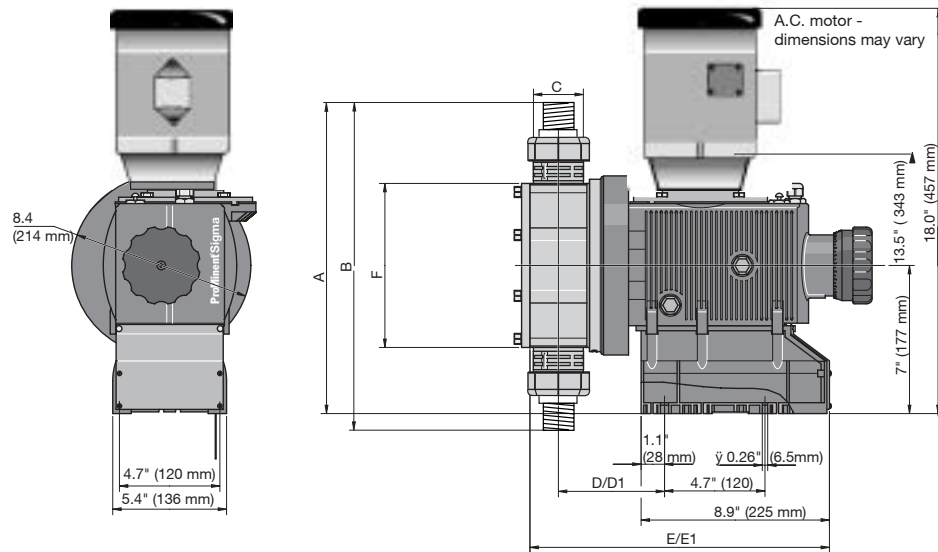

Dimensions in inches (mm)

Type Sigma/3	A	B	Suction/ Discharge Valve Thread C*	D	D1**	E	E1**	F
121045, 120190, 120270								
PVT	14.1 (358)	14.3 (364)	1" MNPT	4.7 (120)	5.5 (140)	13.6 (346)	14.4 (366)	6.1 (156)
SST	14.1 (358)	14.3 (364)	1" MNPT	4.8 (121)	5.6 (141)	13.7 (349)	14.5 (369)	6.1 (156)
07042, 04084, 04120								
PVT	15.9 (403)	17.8 (453)	1-1/2" MNPT	5.0 (127)	5.7 (147)	14.0 (358)	14.8 (378)	8.1 (206)
SST	15.3 (387)	16.9 (430)	1-1/2" MNPT	5.0 (127)	5.7 (147)	14.0 (358)	14.8 (378)	8.1 (206)

* Piping adapters provided according to technical data.

** Dimensions with diaphragm failure detector.

ProMinent® Sigma/3 Motor-Driven Metering Pumps Control Version S3Ca

Sigma/3 Control Version

The microprocessor-based electronics for the Sigma/3 control version are the same as the Sigma/1 and Sigma/2 metering pumps. Programming functions enable the user to set and retrieve pertinent information easily.

- flow can be set and displayed in either U.S. gph or L/h
- totalized flow is displayed in gallons or Litres
- accumulative stroke counter is displayed
- optional access code can be programmed to prevent unauthorized adjustment to settings
- three LED lights indicate operational status

The S3Ca pump is available with contact and 4-20 mA analog signal control.

Optional monitoring indicators include

- fault annunciating relay for low tank level, loss of flow, system faults and fuse/power supply failure, loss of analog signal, diaphragm rupture
- pacing relay to pace a second pump or totalize flow with an external stroke counter
- Profibus field bus connection for remote monitor and control

Pumps can also be ordered with a diaphragm failure monitor.



Sigma/3 Microprocessor Control

Standard Control Modes and Functions

Feed rate is determined by stroke length and stroke rate. Stroke length is manually adjustable from 1 to 100% in increments of 0.5% via the stroke length knob.

Stroke rate can be set to a maximum of 90, 120 or 180 strokes per minute (pump dependent). An illuminated LCD displays stroke length, stroke rate and an accumulative stroke counter, which can be cleared and reset.

Pump capacity output is displayed in either U.S. gph or L/h, set by the operator. Output is accumulated and totaled capacity is also displayed in either U.S. gallons or litres.

The “i” key is used to scroll information screens for stroke rate, stroke length, stroke counter, capacity and totaled capacity. Other information is available depending on control mode.

Control Modes

Three control modes are available with the Sigma/3: manual, external contact with pulse control (multiplier/divider), batch, or analog control. The basic version includes manual and external contact with pulse control. The Profibus option includes all control modes, plus fieldbus connection.

In the “Manual” mode, stroke rate is controlled manually. The “Contact” external mode allows adjustments to be made externally (e.g. by means of a pulse-type water meter for proportional chemical feed). Pulse signals are fed into the contact input of the pump by an optional control cable. Each pulse from a water meter or pulse-type controller provides the pump an input to pump at the selected pulse ratio, up to the pump's maximum stroke rate. Over-stroking the pump is not possible.

Standard Functions

“Calibrate”

The pump can be directly calibrated in-line to actual flow. Calibration is maintained within the stroke frequency range of 90/120/180 spm (model dependent). A warning indicator flashes when adjustments to the stroke volume are made outside the calibrated range of +/- 10%.

“Auxiliary Frequency”

An auxiliary frequency can be programmed. This default stroking rate can be enabled via the optional control cable.

“Flow”

The Sigma/3 series metering pumps will monitor their own output, with an optional adjustable flow monitor. Every fluid discharge is sensed and fed back to the electronic control circuit of the pump. If insufficient fluid is discharged for a predetermined number of strokes (up to 125), the pump automatically stops and the red LED lights. The optional fault relay changes state to issue an alarm or activate a standby pump. Call for availability.

“Float Switch”

An optional two-stage ProMinent float switch can be plugged into the pump to monitor chemical levels in the source tank. An early warning is issued when the allowable minimum level is reached. The pump continues to operate while the display flashes, the yellow LED lights and an optional collective fault relay changes state to issue an alarm. If the liquid level in the supply tank drops another 3/4" (20 mm), the pump automatically shuts down, the LCD displays “Minim” and the

red LED lights. The optional fault relay remains activated.

“Pause”

The Sigma/3 series can be remotely started or stopped via a dry contact through the optional control cable.

“Stop”

The Sigma/3 can be stopped by pressing the STOP/START key without disconnecting from the main power supply.

“Prime”

Priming is activated by pressing both arrow keys at the same time while the frequency display is showing.

Function and Error Indicators

Three LED lights on the pump faceplate signal operational status. The green light flashes during normal operation, and the yellow light warns of a situation that could lead to a fault (e.g. low chemical). If a fault occurs “error” will appear on the LCD screen and the red LED light appears.

Sigma/3

Optional Control Modes and Features

Optional Control Modes

"Analog" Mode

With this option, the stroking rate of the Sigma/3 is directly proportional to the analog signal. For a custom range setting, the curve feature of the analog input can be selected. With this, the pump response to the analog input can be easily programmed.

"Contact" Mode with Pulse Control

This feature is used to "tune" the pump to contact generators of any kind (e.g. pulse-type water meter or process controller), and eliminate the need for a costly external control unit. The following functions can be selected by means of the keypad.

Pulse step-up (multiply) and step-down (divide)

By simply entering a factor in the 0.01-99.99 range, the step-up or step-down ratio is set.

For example:

Step-up Factor:

99.99 1 pulse = 99.99 pump strokes

10 1 pulse = 10 pump strokes

Step-down Factor:

0.25 4 pulses = 1 pump stroke

0.01 100 pulses = 1 pump stroke

"Batch" Mode

The Batch mode is a variation of the contact operating mode. A number of strokes can be predetermined up to 65,535 strokes (whole numbers) or the feed quantity can be predetermined. The batch is then initiated by either pressing the "P" key on the pump face or providing a contact to the external control cable.

Access Code

A programmable access code to prevent unauthorized changes to settings is available as an option.

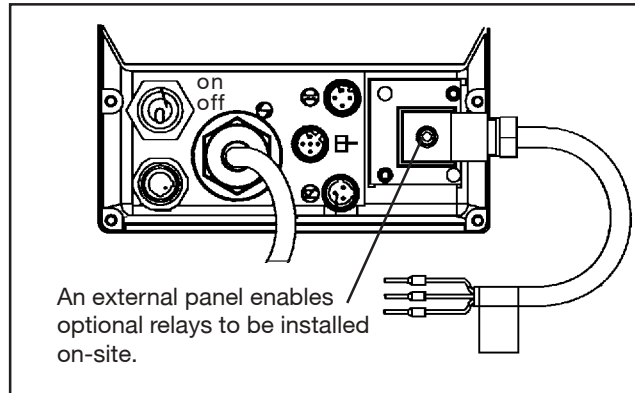

Relay outputs. . .

Fault annunciating relay

For low tank level (flow switch), loss of flow (flow monitor), system faults, loss of analog signal and diaphragm rupture monitor and fuse/power supply failure.

Fault annunciating and Pacing relay

In addition to the fault annunciating relay, a contact closure is issued with every pump stroke (contact duration 150 ms). This allows a second ProMinent metering pump to be paced synchronously, or to totalize flow with an external stroke counter.

4-20 mA Analog Output

A 4-20 mA analog output option is available for use with pumps that operate in the manual mode or by a remote 4-20 mA analog reference signal. The 4-20 mA analog output signal is linear to pump frequency multiplied by the percentage of stroke length. The output signal is isolated and can drive up to 300 Ohms impedance. Analog output can be used for status feedback to higher level control systems for closed loop control or for monitoring chemical usage. This option is available in combination with either the fault annunciating or pacing relay.

Timer Relay

The optional integrated 2-week timer offers 81 programmable events. It can be set to hourly, daily, work days, weekend, weekly or two-week periods with switch-on times from 1 second to two weeks. The timer can be programmed to change operation mode, frequency and the function of two relays. All the functions can be programmed independently of one another. Up to 13 delay times can be programmed into the timer function.

The range of applications exceeds that of a "standard timer". Typical application is disinfection in cooling towers, process water, etc. with the ability to automatically program shock dosages or increase the concentration at a certain interval.

Fieldbus connection

Monitor and control remotely via a SCADA/PLC system using the profibus-DP system.

Note: Relay options not available with profibus. Profibus is not field retrofittable.

Identity code: Control Version Sigma/3 HM (S3Ca)

Series:
S3Ca Sigma/3 Control
Version a

H	Main drive/Diaphragm													
	Pump version: 120145 070410 120190 070580 120270 040830													
	PVT	Liquid end material: PVDF with PTFE/Viton® seal												
	SST	316 Stainless steel with PTFE/Viton® seal Viton® is a registered trademark of DuPont Dow Elastomers												
		0	Diaphragm type: Standard diaphragm, PTFE											
		1	With double diaphragm and failure monitor (NC contact opens on fault)											
		2	With double diaphragm and failure monitor (alarm & continues to operate)											
		0	Liquid end version: Without valve springs											
		1	With 2 valve springs (Hastelloy C4, 1.45 psig) (standard for 070410, 070580, 040830)											
		7	Connectors: PVDF clamping nut & insert											
		8	SS clamping nut & insert											
		0	Labeling: Standard with logo											
		W	Voltage supply: 1 ph, 115-230V ± 10%, 50/60 Hz											
		A	Cable and plug with 6 ft (2 m) power cord, single phase: European plug, 230V											
		D	N. American plug, 115 V											
		U	N. American plug, 230 V											
		0	Relay: Without relay (For Profibus only)											
		1	Fault annunciating relay, drops out (Standard)											
		3	Fault annunciating relay, pulls in											
		4	Option 1 + pacing relay											
		5	Option 3 + pacing relay											
		C	Option 1 + 4-20 mA output											
		D	Option 3 + 4-20 mA output											
		E	Pacing relay + 4-20 mA output											
		F	High current relay drops out											
		G	High current relay pulls in											
		0	Control Variants: Manual + External with pulse control (multiplier/divider)											
		1	Manual + External with pulse control & analog control											
		4	Option 0 + timer											
		5	Option 1 + timer											
		P	Option 1+ Profibus (Relay must be 0)											
		0	Access Code: No Access Code											
		1	Access Code											
		0	Flow Monitor: Input for metering monitor signal (pulse)											
		1	Input for maintained flow switch signal											
		C	Stroke Length Adjustment: Manual + Calibration											
S3Ca	H	040830	PVT	0	0	7	0	W	D	0	0	0	0	C

Dimensions: Sigma/3 HM Control (S3Ca)

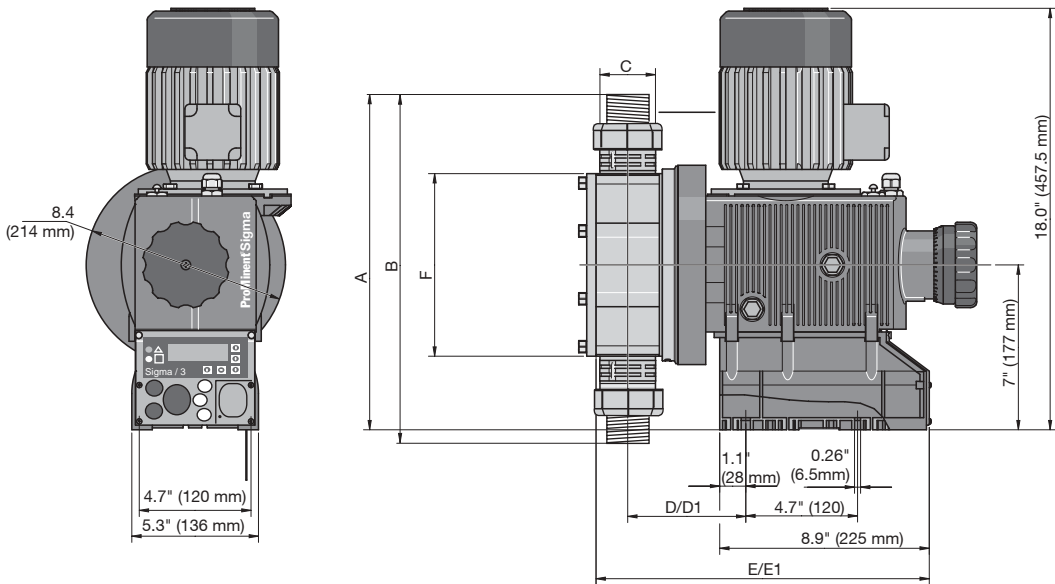

Dimensions in inches (mm)

Type	Sigma/3	A	B	Suction/ Discharge Valve Thread C*	D	D1**	E	E1**	F
121045, 120190, 120270									
PVT		14.1 (358)	14.3 (364)	1" MNPT	4.7 (120)	5.5 (140)	13.6 (346)	14.4 (366)	6.1 (156)
SST		14.1 (358)	14.3 (364)	1" MNPT	4.8 (121)	5.6 (141)	13.7 (349)	14.5 (369)	6.1 (156)
07042, 04084, 04120									
PVT		15.9 (403)	17.8 (453)	1-1/2" MNPT	5.0 (127)	5.7 (147)	14.0 (358)	14.8 (378)	8.1 (206)
SST		15.3 (387)	16.9 (430)	1-1/2" MNPT	5.0 (127)	5.7 (147)	14.0 (358)	14.8 (378)	8.1 (206)

* Piping adapters provided according to technical data.

** Dimensions with diaphragm failure detector.

ProMinent® Sigma/3

Metering monitor

Description

Part No.

Metering monitor

Adjustable metering monitor "Flow Control"

For S3Ca HM with connection cable for assembly directly to liquid end.

Monitors individual strokes according to the float and orifice principle. The partial quantity of chemical flowing past the float is adjusted from the total stroke volume via the adjusting screw so that an alarm is actuated if there is no pump flow. The user can select the number of incomplete strokes permitted (between 1 and 125) in accordance with the actual process requirements.

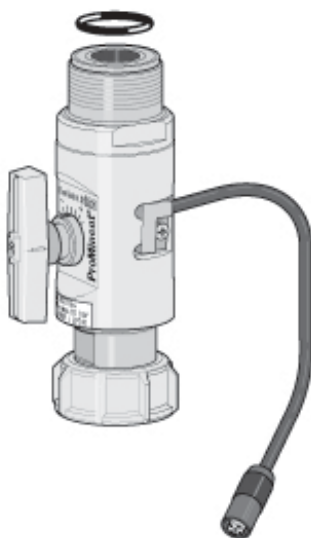

Materials:

Flow meter: PVDF
 Float: PTFE-coated
 Seals: Viton® /EPDM

FlowControl	Material	for pump type	
Flow Control DN25	PVDF, EPDM	120145, 120190, 120270	1021164
Flow Control DN25	PVDF, Viton®	120145, 120190, 120270	1021165
Flow Control DN32	PVDF, EPDM	070410, 070580,040830	1021166
Flow Control DN32	PVDF, Viton®	070410, 070580,040830	1021167

Flow monitor

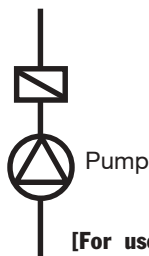

[For use with low-viscosity (water-like) fluids only].

Viton® is a registered trademark of DuPont Dow Elastomers

ProMinent® Sigma/3

Control cables

Description	Part No.
-------------	----------

External control cables

Universal control cable

For metering pump control via contact closure (pulse), standard process signal (analog), and voltage-free contact for remote pause control and auxiliary frequency.

For Sigma pumps with 5-pole round plastic connector and 5-wire cable with loose end.

Universal control cable, 5-pole round connector, 5-wire, 6 ft. (2 m)	1001300
Universal control cable, 5-pole round connector, 5-wire, 16.4 ft. (5 m)	1001301
Universal control cable, 5-pole round connector, 5-wire, 32.8 ft. (10 m)	1001302

ON/OFF Control (Pause)

BROWN and BLACK wires must be connected together via an ON/OFF contact or shorted together. When the contact is closed between the BLACK & BROWN wires, the pump will run. When the contact is open, the pump will stop.

Note: If ON/OFF control is the only control feature being used, WHITE, BLUE & GREY wires are not used and should be cut back.

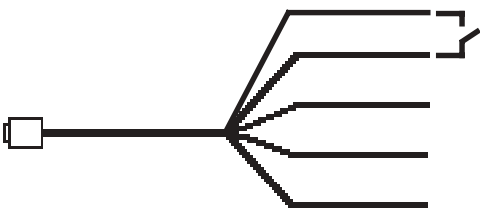

BROWN: Remote On/Off (+)

BLACK: Common

GREY: Auxiliary Frequency

WHITE: Pulse (+)

BLUE: Analog (+)

Pulse Control

Pulse control will allow the pump to run in proportion to a pulsing potential free contact closure.

Note: BROWN and BLACK wires have to be connected together via an ON/OFF contact or shorted together. GREY wire is not used and should be cut back.

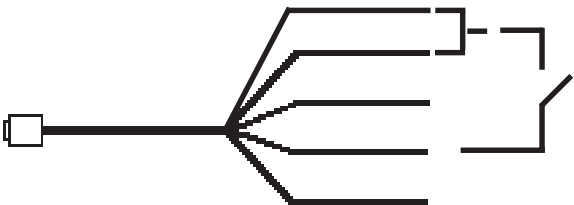

BROWN: Remote On/Off (+)

BLACK: Common

GREY: Auxiliary Frequency

WHITE: Pulse (+)

BLUE: Analog (+)

ProMinent® Sigma/3 Control cables

Description

Part No.

External control cables

Analog Control

Analog control runs in proportion to an analog signal such as 4 - 20 mA.

Note: BROWN and BLACK wires must be connected together via an ON/OFF contact or shorted together. The BLACK wire is negative and the BLUE wire is positive. GREY wire is not used and should be cut back.

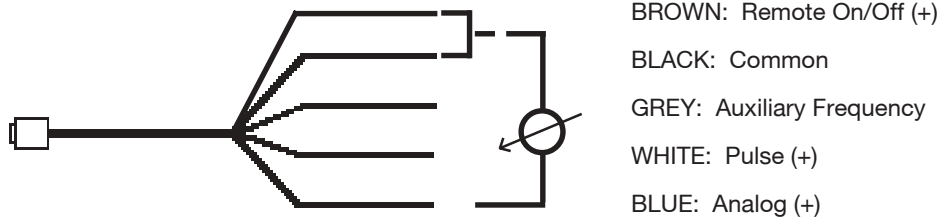

Auxiliary Frequency

Auxiliary frequency will allow the pump to default to a predetermined stroking frequency regardless of which operating mode the pump is in. The pump defaults to this stroking frequency as long as a contact is closed between the black and grey wires of the universal control cable.

Note: BROWN and BLACK wires must be connected together via an ON/OFF contact or shorted together.

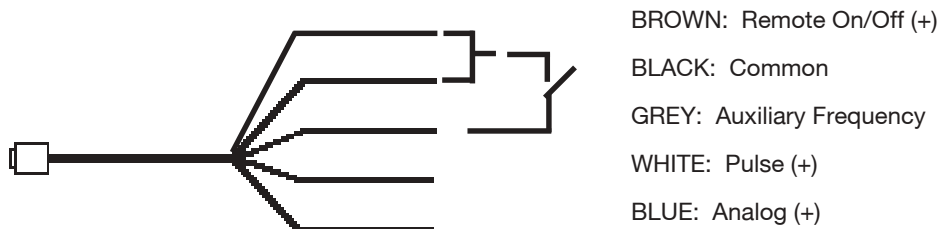

ProMinent® Sigma/3 Spare Parts

Spare Parts and Liquid Ends

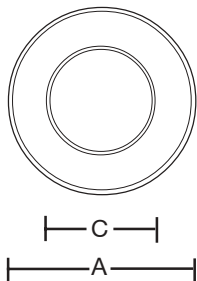
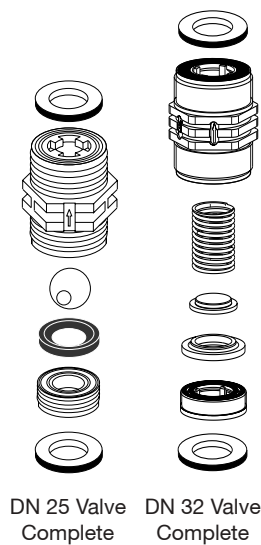

Liquid End	Dim A (mm)	Dim C (mm)
FM 330	120	80
FM 1000	175	135

Complete liquid ends include pump head, valves, mounting screws, diaphragm and backplate. Clamping nuts and inserts are not included with complete liquid ends, complete valves or spare parts kits (see the High Flow Accessories section for these parts). Spare parts kits include:

PVT Liquid ends

- 1 Diaphragm
- 1 Suction valve, complete
- 1 Discharge valve, complete
- 2 Valve balls
- 1 Set of seals, complete

SST Liquid ends

- 1 Diaphragm
- 2 Valve balls
- 1 Set of seals, complete (sleeve rings, ball seat rings)

Material Code	Liquid End Complete	Spare Parts Kit	Valve Complete	Diaphragm
<u>120145, 120190, 120270, with Liquid end FM 330 - DN 25</u>				
PVT	1005298	1005308	740615	1004604
SST	1005300	1005312	803708	1004604
SST*		1005310		1004604
<u>070410, 070580, 040830, with Liquid end FM 1000 - DN 32</u>				
PVT	1005297	1005309	1002806	1002835
SST	1005299	1005313	1002811	1002835
SST*		1005311		1002835

*Without valves

((THIS IS A MASTER, EDIT FOR SPECIFIC APPLICATION))

PROMINENT FLUID CONTROLS, INC. – SIGMA/3 HM (for flow rates from 46 to 264 gph)

ProMinent®

PART 1 – GENERAL

1.1 GENERAL

- A. This specification covers the supply, installation, and testing of a complete functional metering pump system including all accessories and appurtenances as shown on the drawings and described herein. A single chemical metering pump manufacturer shall be responsible for supplying all components of the metering feed system.

1.2 QUALITY ASSURANCE

- A. For the purpose of establishing quality assurance, experience, and system reliability, the products described herein are based on those metering pumps manufactured by ProMinent Fluid Controls, Inc. All pumps shall be shop-tested for capacity at rated pressure prior to shipment, with documented results provided.

1.3 WARRANTY

- A. The chemical metering pump manufacturer shall provide a two year warranty on the metering pump mechanical drive and one year on the liquid end.

PART 2 – PRODUCTS

2.1 GENERAL

- A. Manufacturers:
 - 1. ProMinent Fluid Controls, Inc.
 - 2. Pre-approved equal.

2.2 DESCRIPTION

- A. The chemical metering pump shall be a simplex, motor-driven, reciprocating, mechanically-actuated diaphragm type. The pump shall include integral motor, oil-lubricated gear reducer, and cam-and-spring drive mounted in an aluminum housing. Such housing to be sealed into an outer plastic housing for corrosion protection with heat sinks for cooling.
- B. The power supply shall be ___ VAC, ___ Hz, ___ Phase.
- C. The liquid end shall be physically separated from the drive unit by a back plate with weep hole creating air gap separation. An elastomer shaft wiper seal shall prevent contamination of the gear box by confining chemical within the back plate if the primary diaphragm fails. The primary diaphragm shall have a steel core, vulcanized into a nylon-reinforced EPDM backing, with PTFE-faced fluid contact surface.
- D. ((OPTIONAL)) The liquid end shall also feature a secondary diaphragm separated from the primary diaphragm by a spacer plate with diaphragm-isolated pressure switch to close a contact for alarm annunciation and to prevent chemical spill or intrusion into pump drive upon failure of the primary diaphragm.

2.3 LIQUID END

- A. The diaphragm shall be of a convex design fitting into a concave liquid end to minimize diaphragm wear, liquid end dead volume, and to promote flow of solids in suspension.

((SELECT ONE))

- The liquid end shall be virgin PVDF. The suction and discharge valve shall be PVDF with PTFE faced Viton gasket seals and ceramic valve balls.

Or

- The liquid end shall be 316 stainless steel. The suction and discharge valves shall be 316 stainless steel with PTFE-faced Viton gasket seals and stainless steel valve balls.

2.4 CONTROL ((BASIC VERSION PUMP))

A. Stroke length control of the basic version pump

((SELECT ONE))

- shall be adjustable manually by means of a stroke length knob, in increments of 0.5%, from 0% to 100% of stroke length.

Or

- shall be adjustable by means of a stroke positioning motor from 0% to 100% of stroke length. The stroke positioning motor shall feature visual stroke length indication and manual/ external selector switch for local control via toggle switch or external control in proportion to a 4-20 mA signal.

B. Stroke frequency control of the basic version pump

((SELECT ONE))

- shall be fixed at the pump's maximum stroke rate. Pump shall include a 3/4 HP, TEFC, four-pole AC motor.

Or

- shall be controlled by DC SCR drive system for stroke frequency control. The SCR shall include a wall mountable NEMA 4 enclosure with on/off switch, manual/external switch and speed potentiometer. The DC voltage output to the motor shall be proportional to the potentiometer setting in manual mode, or proportional to an external 4-20 mA signal in external mode. Pump shall include a 3/4 HP, TENV, permanent magnet 90V DC motor.

Or

- shall be controlled by an SCR drive system for stroke frequency control. The SCR shall include a wall mountable NEMA 4 enclosure with on/off switch, manual/external switch and membrane keypad and digital display spannable to show RPM, percent output or flow rate. The actual motor speed, as measured by motor-mounted tachometer, shall be proportional to the rate setting in manual mode, or proportional to an external 4-20 mA signal in external mode. Pump shall include a 3/4 HP, TENV, permanent magnet 90V DC motor and Tach.

Or

- shall be controlled by an AC inverter system for stroke frequency control. The inverter shall include a wall mountable NEMA 4/12 enclosure with keypad and display of % load or output voltage. Selectable for local or remote operation via 4-20 mA signal. Pump shall include a 3/4 HP, inverter duty, 3-phase, 208-230 VAC motor. Minimum speed 3-30 Hz.

2.5 PROGRAMMING AND CONTROL ((CONTROL VERSION PUMP))

A. The metering pump shall be microprocessor-controlled. All pumping functions shall be set by membrane-switch keypad and status shall be displayed on an illuminated LCD, which is readable at an offset of 45 degrees. Keypad will allow for simple scrolling of programmed parameters.

B. Stroke length control shall be adjustable manually by means of a stroke length, in increments of 0.5%, from 0 to 100% of stroke length. The LCD shall digitally display stroke length in 1% increments in the full range between 100% and 0%.

- C. Programming shall allow pump to be calibrated so as to display pump output in gallons/hour or liters/hour. Calibration shall be maintained when stroke length is altered up to +/-10% on the stroke length knob. If stroke length is altered by more than +/-10%, a yellow warning light will light and a flashing message "calib" will appear.
- D. The pump shall be equipped with the programmable function of electronic interlocking of the keypad by access code to prevent unauthorized adjustments to the pump.
- E. Keypad shall allow for scrolling and display on LCD such parameters as stroke frequency, stroke length, stroke counter, pump output in gals/hr or l/hr, dosing quantity, mA input being received by pump, and indication of external mode.
- F. An AC inverter shall be integral to the microprocessor control and function of the pump. While 115VAC or 230VAC, 1 phase may be used to power the pump, the inverter shall drive a 1/2 HP, 230VAC, 3 phase motor. Stroke frequency shall be accomplished through microprocessor control with proportional start/stop of the motor, from 0% to 33% of stroke rate. Stroke rate shall be accomplished through variable speed of the motor from 34% to 100% of stroke rate. Stroke frequency control shall be manually adjusted by touch keypads, with the set stroke rate displayed on the LCD. The pump shall be capable of receiving a pulse input via optional external control cable such that one pulse gives one pump stroke rate. The pump shall be capable of remote ON-OFF operation using the pause function via a voltage free contact relay through an optional control cable. In addition, the pump shall be configured with;

((OPTIONAL SELECTIONS))

- pulse multiplier/divider functionality. The pump shall allow factoring to issue from 1 to 99.99 strokes per pulse input or to issue 1 stroke per 1 to 100 input pulses.

Or

- analog input functionality. The pump shall accept an analog signal such that stroke frequency is proportional to 4-20mA or 20-4mA, the choice of which is programmed at the pump. The pump shall allow the setting of a maximum stroke rate, which corresponds to the maximum analog signal, with stroke rate proportional to signal strength below that rate. Programming for curve processing shall also be possible, in which any stroke frequency ratio in proportion to the electrical signal can be configured. Analog to digital converters external to the pump shall not be acceptable.

Or

- pulse multiplier/divider and analog input functionality. The pump shall allow factoring to issue from 1 to 99.99 strokes per pulse input or to issue 1 stroke per 1 to 100 input pulses. The pump shall also accept an analog signal such that stroke frequency is proportional to 4-20mA or 20-4mA, the choice of which is programmed at the pump. The pump shall allow the setting of a maximum stroke rate, which corresponds to the maximum analog signal, with stroke rate proportional to signal strength below that rate. Programming for curve processing shall also be possible, in which any stroke frequency ratio in proportion to the electrical signal can be configured. Analog to digital converters external to the pump shall not be acceptable.

Or

- programmable timer functionality. The pump shall be configured with an integral and programmable 2-week, 81 event timer to change the operational state of the pump. Timers external to the pump are not acceptable.

Or

- pulse multiplier/divider, analog input, and programmable timer functionality (as described above).

- G. The pump shall be equipped with the programmable function of auxiliary frequency control, allowing for quick priming of the pump or for slug feed of process during initial start up after shutdown. Stroke frequency shall be programmable to the maximum for the pump, and the auxiliary frequency function shall be capable of interfacing with a contact closure for control purposes.

2.6 FLOW ASSURANCE ((OPTIONAL))

- A. Low Level Control - A 2-stage Float Switch shall be supplied to stop the pump prior to losing prime and annunciate low level on the pump LED.

- B. Relay Output - An SPDT relay shall be installed on the pump for:

((SELECT ONE))

- fault indication. ((OPTIONAL)) The metering pump shall have an integral relay to allow remote annunciation of a fault condition (i.e. low supply solution early warning/lack of supply solution shut down, loss of chemical output, system faults, and fuse/power supply failure). Configure as ((N/O//N/C)) contact closure relay.

Or

- both fault indication and pacing relay. ((OPTIONAL)) The metering pump shall have an integral relay to allow remote annunciation of a fault condition (i.e. low supply solution early warning/lack of supply solution shut down, loss of chemical output, system faults, and fuse/power supply failure). Configure as ((N/O//N/C)) contact closure relay. The pacing relay shall issue a contact closure with every pump stroke to pace a second metering pump. The pacing relay shall be electrically isolated via an optical coupler with a semiconductor switch.

Or

- both 4-20mA output and fault indication. ((OPTIONAL)) The analog output function shall be a multiplicative factor of both stroke length % and stroke frequency %, reflecting the real time output capacity of the metering pump. The metering pump shall also have an integral relay to allow remote annunciation of a fault condition (i.e. low supply solution early warning/lack of supply solution shut down, loss of chemical output, system faults, and fuse/power supply failure). Configure as ((N/O//N/C)) contact closure relay.

Or

- both 4-20mA output and pacing relay. ((OPTIONAL)) The analog output function shall be a multiplicative factor of both stroke length % and stroke frequency %, reflecting the real time output capacity of the metering pump. The pump shall also have an integral relay to issue a contact closure with every pump stroke to pace a second metering pump. The pacing relay shall be electrically isolated via an optical coupler with a semiconductor switch.

2.7 ACCESSORIES ((ALL ARE OPTIONAL AND MAY BE INCLUDED AS SEPARATE ITEMS OR AS COMPONENTS OF A PUMP STAND))

- A. The pump shall be mounted on a ((CHOOSE ONE: black, UV-protected polypropylene//304 stainless steel//FRP grating)) support stand suitable for wall, floor or top-of-tank mounting. A single chemical metering pump manufacturer shall be responsible for supplying and assembling all components of the skid, in addition to testing the skid-mounted metering system under conditions of maximum rated pump pressure, prior to shipment. The stand shall include the following accessories, pre-piped;
- B. A foot valve and strainer shall be provided with each pump.
- C. An injection check valve shall be provided with each pump.
- D. A universal control cable with 5-pole round plastic connector and 5-wire cable with loose ends shall be provided with each pump.

- E. A two-stage float switch compatible with the chemical metering pump shall be provided for monitoring tank level.
- F. An adjustable discharge flow monitoring device mounted on a valved bypass shall be provided. The flow monitor shall be capable of signaling a fault condition to the metering pump.
- G. A diaphragm failure detector shall be provided to ((open/close)) a contact in the event of diaphragm failure.
- H. An adjustable-pressure, diaphragm-type back pressure/antisiphon valve shall be provided with each metering pump.
- I. An in-line, adjustable-pressure, diaphragm-type pressure relief valve shall be provided with each metering pump.
- J. An air-charged, bladder-type pulsation dampener shall be provided with each metering pump.
- K. A clear PVC calibration column with FNPT fittings top and bottom shall be provided with each pump//skid.

2.8 APPLICATION

- A. Quantity:
- B. Chemical Service:
- C. Capacity (U.S. gph):
- D. Back Pressure (psig):

END OF SECTION

Sigma/3 Metering Pumps

Special Notes

- S3Ba basic version:
 - Motor **not included** (56 C flange)
 - **No** control panel
- S3Ca control version:
 - Braking motor **included**
 - Includes a control panel for manual frequency adjustment or external control
- For external control (remote on/off, contact pulse, analog, auxiliary frequency) a ProMinent control cable is required.
- Foot valves and injection valves are **not included**. Please refer to High Flow Accessory Section.
- A pressure relief valve **is required** when pumping into a pressurized discharge line.
- Pulsation dampeners are recommended for applications where discharge lines are over 100 ft. or if hydraulic circumstances require it.