

TOMAL® Multiscrew Feeders

For Safe Discharge and Accurate Metering of Solids

The **TOMAL® Multiscrew Feeder** is the core of all ProMinent® dry feed packages. Application specific systems are available to satisfy the dry feed handling, mixing, delivering and controlling requirements for all of your dry feed needs in both the Municipal and Industrial market place.

With unique construction, **TOMAL® Multiscrew Feeders** are outstandingly suitable as metering devices for both granular and arch-forming materials.

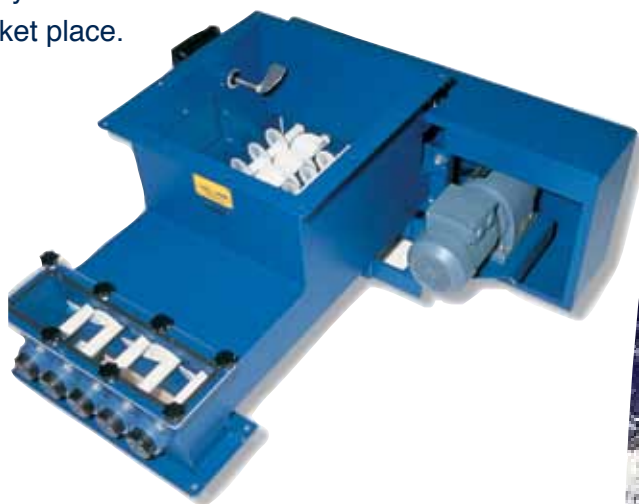

Advantages

- Multi screw design
- High metering accuracy
- Linear discharge curve
- Forced discharge
- Self-cleaning feeder screws
- Large active contact area
- Robust low-wear construction

Example of Typical Materials

- | | |
|--------------------------|-----------------------------|
| ■ Lime | ■ Magnesium Sulfate |
| ■ Polymer | ■ Magnesium Oxide |
| ■ Potassium Permanganate | ■ Limestone |
| ■ Urea | ■ Sodium Bicarbonate |
| ■ Bentonite | ■ Powdered Activated Carbon |
| ■ Aluminium Sulfate | ■ Soda Ash |

ProMinent®

Visit our XTRANET <www.prominentxtranet.com> to:

- sign up for our electronic newsletter
- download literature and manuals
- validate your product warranty

TOMAL® Multiscrew Feeders

Technical Data / Dimensions

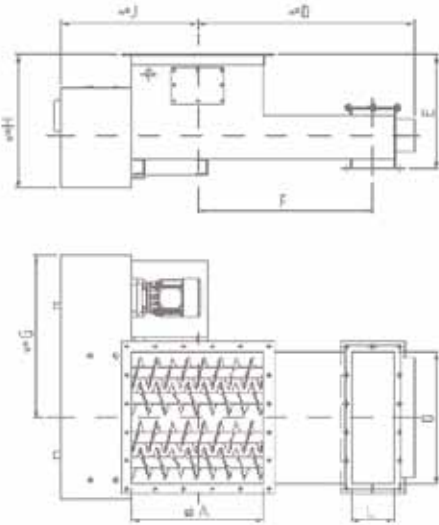

Feeder Type	182	224	302	403	405	475	624	626	627	1004	1254
A	7.09	8.66	11.81	15.75	15.75	27.56 / 15.75	24.41	24.41	24.41	39.37	49.21
D	13.39	16.14	22.64	39.17	24.61	30.51	41.04 / 47.64	28.54	28.54	58.46	77.76
E	8.46	12.20	12.99	20.87	14.96	14.94	21.26	19.09	16.34	24.41	29.33
F	10.24	12.80	17.72	31.50	19.69	25.59	32.36 / 39.37	23.62	23.62	48.23	65.04
G	11.81	14.57	17.72	25.98	21.65	21.65	29.92	25.98	25.98	38.58	44.69
H	10.43	14.17	17.32	24.02	18.11	17.32	22.83	22.05	18.31	25.00	30.91
J	10.83	10.71	13.78	21.06	18.11	21.65	23.23	20.87	23.62	38.58	42.32
L	2.36	3.15	3.94	7.87	3.94	3.94	7.87	3.94	3.94	11.02	13.78
O	4.72	8.66	7.09	17.17	15.75	15.75	24.41	2 x 9.06	24.41	39.37	49.21
Nos of Screws	2	4	2	3	5	5	4	2 x 3	7	4	4
Max Cap lbs/min	1.8	29.4	73	529.5	176.5	176.5	735	2 x 132	294	2647	6472

*All measurements in inches unless otherwise noted
 ** All rates based on 50lbs/cu³ bulk density

High Metering Accuracy

A number of interacting counter rotating feeder screws are able to create blocking zones between them. This ensures extremely high accuracy as the screws are self-cleaning.

Linear Discharge Curve

The discharge curve is linear. In conjunction with speed and discharge per time.

Assuming the material has constant volume weight, the accuracy will be better than +/- 1%. This enables both batch and continuous processes to be accurately controlled.

Safe Product Discharge

TOMAL®'s multiscrew design ensures that material is discharged over the entire active area of the feeder. This prevents the material from bridging and ensures that the principle of "first in, first out" is maintained.

Optional level monitoring is available to detect arch build-ups for extremely arch-forming materials. This will activate an arch breaking system.

Counter rotating feeder screws

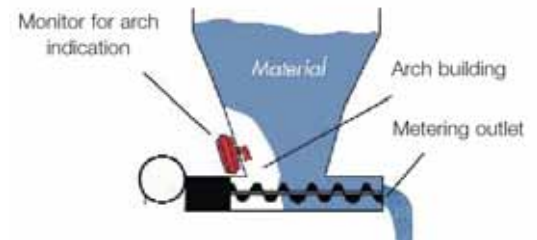
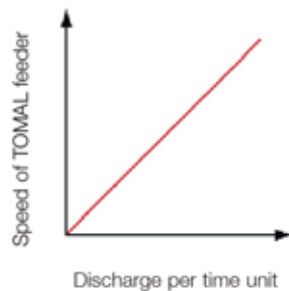
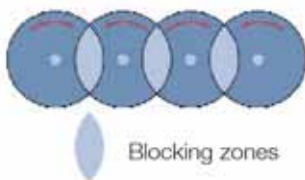

ProMinent®

ProMinent Fluid Controls, Inc. (US)

136 Industry Drive
 Pittsburgh, PA 15275-1014
 Tel: (412) 787-2484
 Fax: (412) 787-0704
 eMail: sales@prominent.us
 www.prominent.us

ProMinent Fluid Controls Ltd. (Canada)

490 Southgate Drive
 Guelph, ON N1G 4P5
 Tel: 1-888-709-9933 | (519) 836-5692
 Fax: (519) 836-5226
 eMail: sales@prominent.ca
 www.prominent.ca